

Assembly instructions:

FT-DW-7492-30

**Milling table base for
DeWalt7492 table saw**

Sauter GmbH
Arzbergerstraße 4
82211 Herrsching

TEL [+49] 08143 99 129 0
FAX [+49] 08143 99 129 29
e-mail: info@sautershop.de
www.sautershop.de

Pre-assembly of the substructure:

1. Fitting the rear leveling screws
2. Fitting the front leveling screws
3. Mounting the support feet

**Carry out steps 1 to 3 for the LEFT
and RIGHT side panel!**

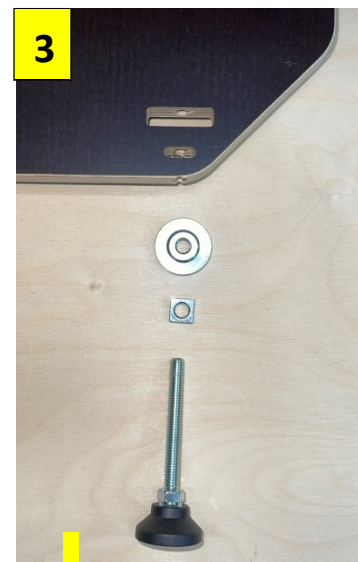
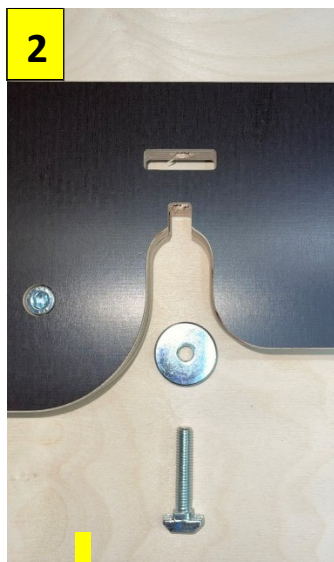
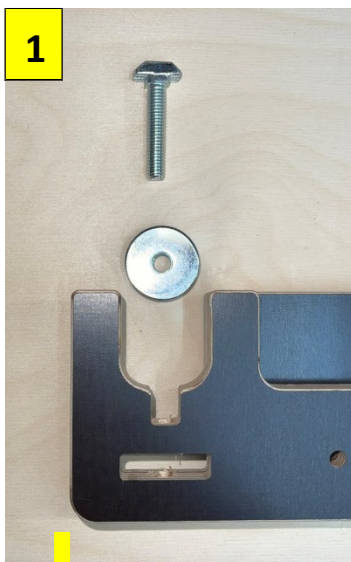

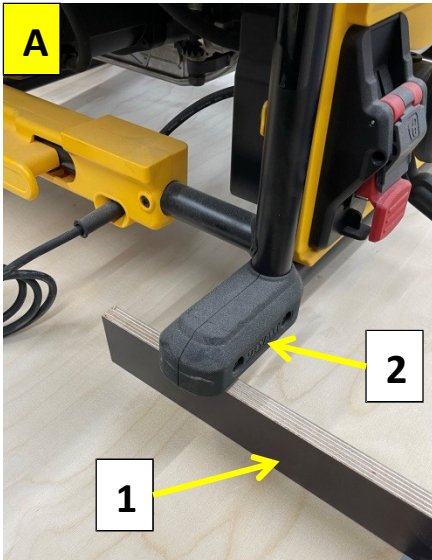

Lift the back of the Saw and place a piece of wood (1) about 5 cm high under the base of the saw (2).

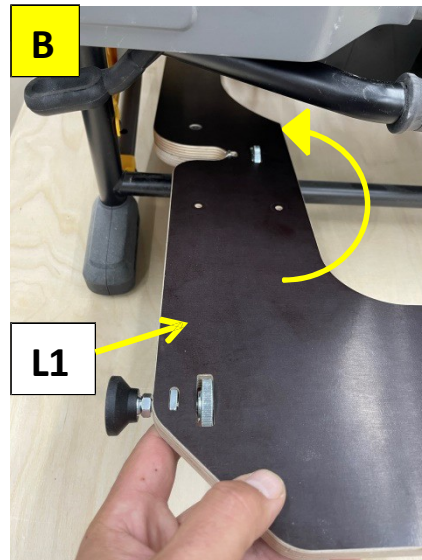

Guide the long side sections (L1) and (R1) flat under the saw and swivel them into an upright position.

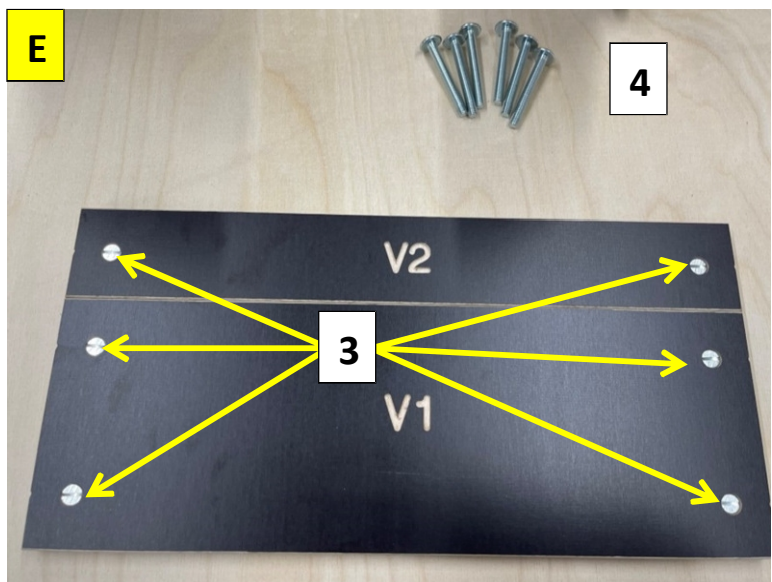
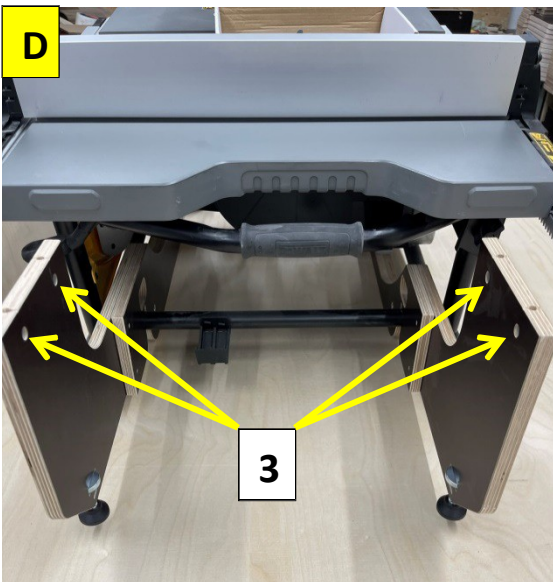
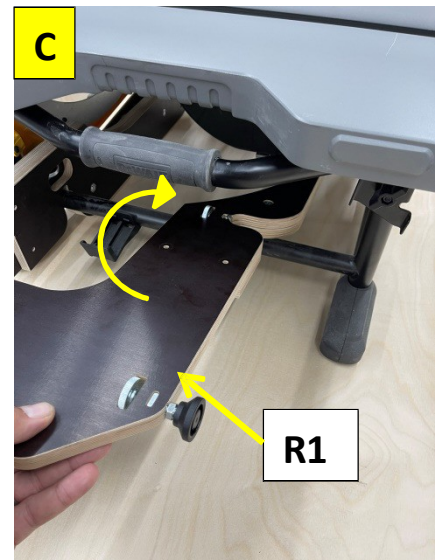

Prepare the cross connectors V1 and V2, as well as the flat head screws M6x50 (4). Insert a cross-hole bolt (3) into each hole.

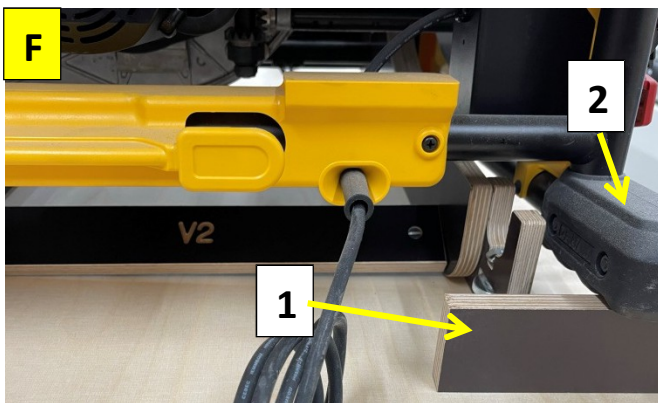

The cross connector V2 is mounted flat on the rear side with one M6x50 screw on each side. The cross connector V1 at the front is mounted upright with 2 M6x50 screws on each side. Tighten all screws firmly and remove the wooden block (1) under the appliance base (2).